



DeLaval™ sort gate DSG10

The gateway to improved profit



Simplify your day

Manual sorting for regrouping cows, inseminations, pregnancy checks, vaccinations, treatments and the like is a profitable, but labor-intensive task.

Effectively completing this function with the ALPRO™ herd management system and DeLaval sort gate DSG10, offers the simplest and most economical approach to realize these benefits.

Sorting your herd for you

DeLaval sort gate DSG10 can reduce your daily labor demands by automatically diverting your herd in up to five different directions, based on various sorting criteria. A flexible, easy-to-use PC interface allows you to select cows directly from the printout or attention note, and batch enter those to be sorted.

ALPRO™ herd management system segregates cows automatically, based on up to 37 reasons in up to eight combinations. When cows match the programmed criteria after milking, they are automatically sorted to the desired area.





www.delaval-us.com
 DeLaval Inc.
 11100 N. Congress Ave.
 Kansas City MO 64153
 USA

www.delaval.ca
 DeLaval Inc.
 2020 Fisher Rd.
 Peterborough, Ontario K9J 787
 CANADA

DeLaval Inc.
 Blvd. Bernardo Quintana #97-4
 Fracc. Villas del Parque
 76140 Queretaro
 MEXICO

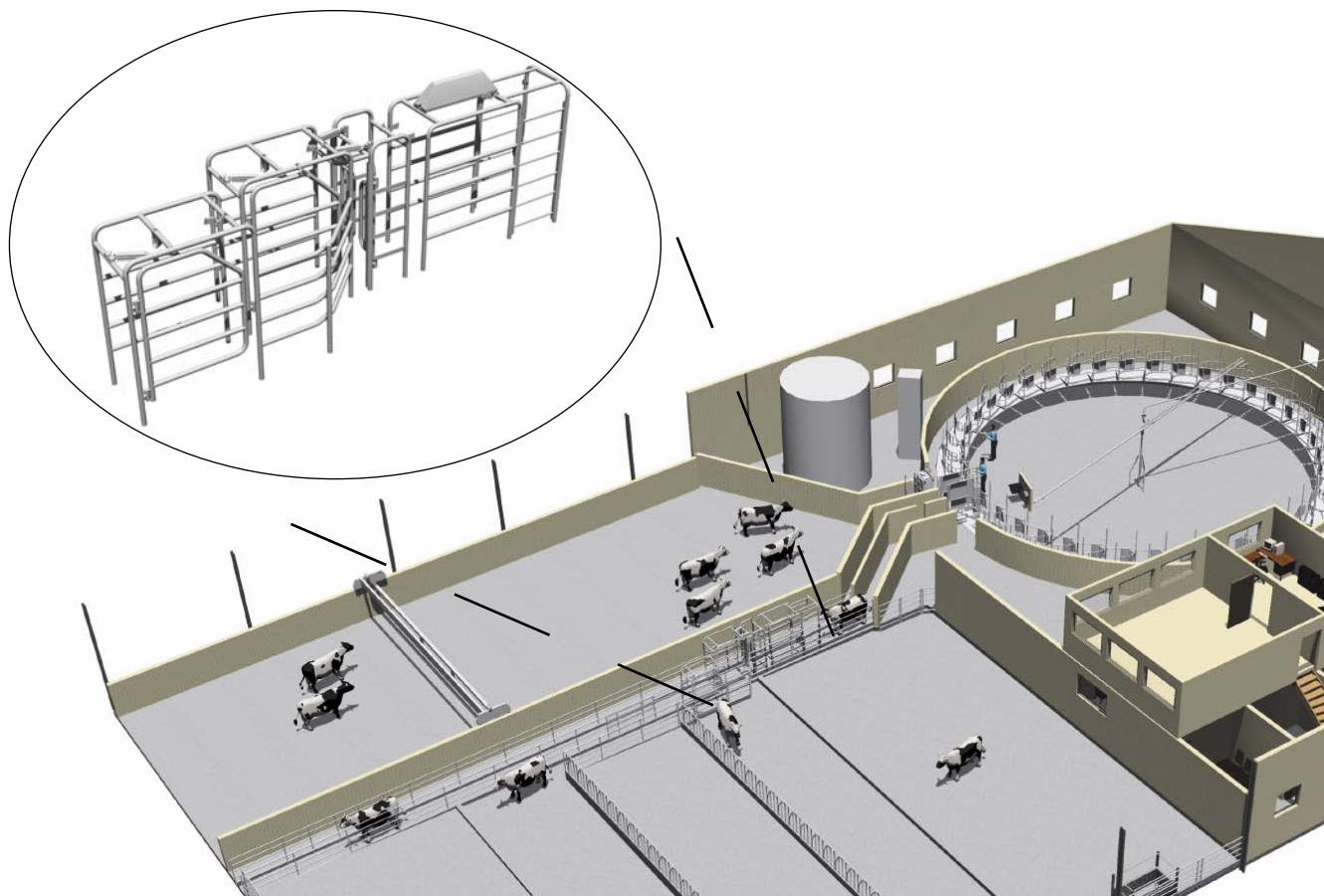

A durable solution

The modular sort system is made of solid stainless steel with compressed-air-operated gates. The sturdy design allows reliable, 24/7 operation with low maintenance and modulation means the system can be installed at any stage.

Cow comfort prioritized

The system's electronic intelligence detects each cow passing through it. This means accurate sorting and normal cow flow are not disrupted. It provides gentle cow treatment and maximum cow-traffic speed without stopping individual animals. A user interface also allows you to separate cows manually.

Data

Number of sorting directions:	Up to 5
Frame:	2" schedule 40 stainless steel pipes
Gates powered by:	Compressed air min. 5 bar max 16 bar
Air consumption:	Max 8 liters, per sorted cow
Environmental protection:	Pneumatics and electronics in a stainless steel cabinet and conduit
Voltage:	12V AC
Electrical power:	10W
Dimensions minimum for 3 way sort gate	
Length:	17ft. (5055mm)
Length, with bolted feet::	17ft. (5255mm)
Width:	3ft. (1000mm)
Width, with bolted feet:	3-1/2ft. (1100mm)
Height including cabinet:	8ft. (2515mm)

Your local independent DeLaval dealer can help plan your cow-sorting facilities to include preferred treatment areas and optimized cow traffic.

